

WINCH

SISTEMI DI APERTURE
OPENING SYSTEMS
ÖFFNUNGSSYSTEME
SYSTEMES D'OUVERTURE
SISTEMAS DE APERTURA

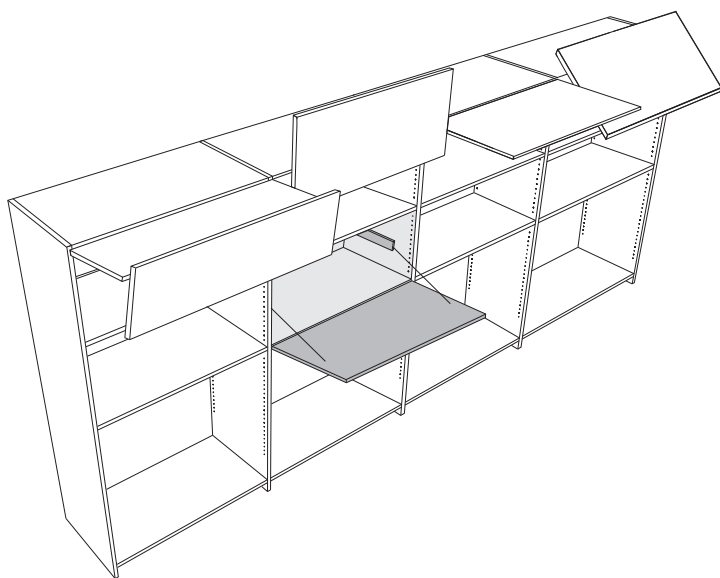

Istruzioni di montaggio e caratteristiche tecniche
Mounting-instructions and technical data
Montage-Anleitung und technische Daten
Instructions de montage et caractéristiques techniques
Instrucciones de montaje y características técnicas

EFFEGIBREVETTI 

Italia - 20090 Segrate (MI) - Via Cava Trombetta 17/25 - ph. +39.02.26921737
- www.effegibrevetti.com info@effegibrevetti.com

Montaggio esterno

Assembly set-on - Externe montage

Montage mécanisme en applique - Montaje externo

Foratura spalla - drilling side-panel - Bohrungen seite
perçage latéral - taladro costado

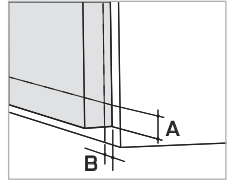
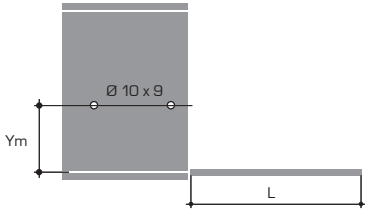

L = 200 - 300
Ym = 122

L = 300 - 430
Ym = 148

L = 430 - 480
Ym = 158

Foratura anta - drilling door - Bohrungen tür
perçage porte - taladro puerta

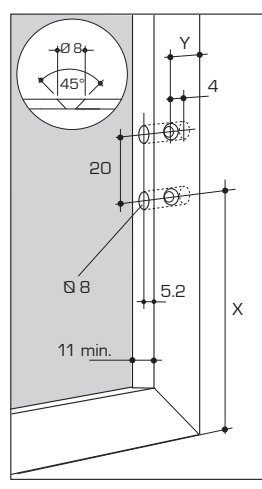
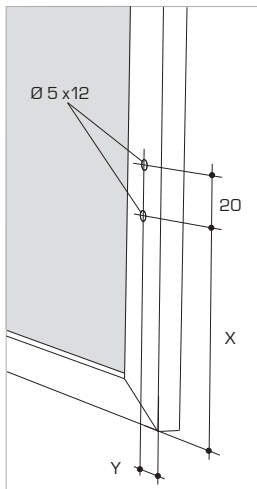
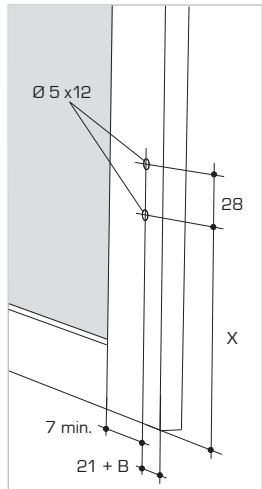
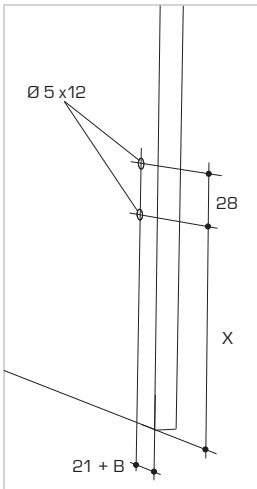

L = 200 - 300
X = 108
Y = 2 + B

L = 300 - 430
X = 134
Y = 2 + B

L = 430 - 480
X = 144
Y = 2 + B



WHATVEXXX36



MLSCX005836

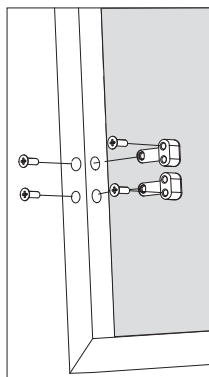

Montaggio incassato

Assembly set-in - Montage eingelassen

Montage mécanisme encastré - Montaje empotrado

Foratura spalla - drilling side-panel - Bohrungen seite
perçage latéral - taladro costado

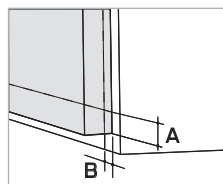
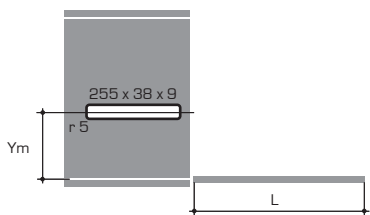

L = 200 - 300
Ym = 122

L = 300 - 430
Ym = 148

L = 430 - 480
Ym = 158

Foratura anta - drilling door - Bohrungen tür
perçage porte - taladro puerta

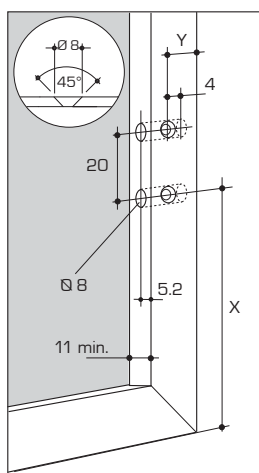
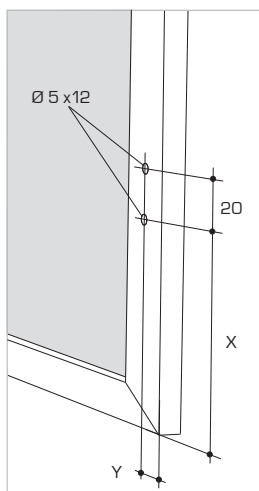
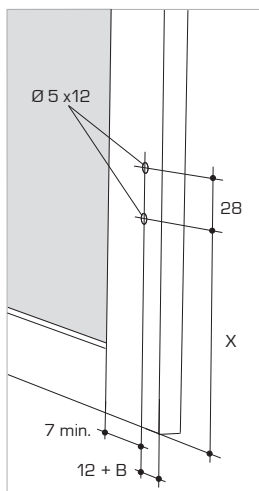
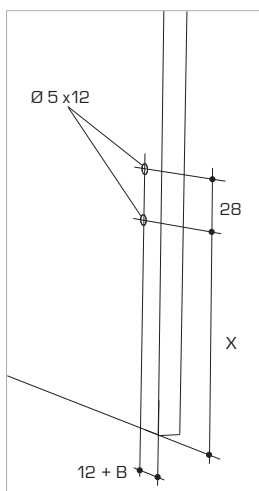

L = 200 - 300
X = 108
Y = -7 + B

L = 300 - 430
X = 134
Y = -7 + B

L = 430 - 480
X = 144
Y = -7 + B

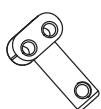

WHATVEXX36



MLSCX005836

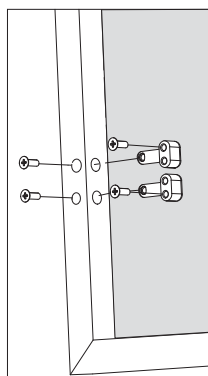

Foratura attacco anta esterno - Drilling door attachment set-on
 Bohrungen Türanbindung zum einlassen - Perçage pour mécanisme en applique -
 Taladro puerta acceso externo

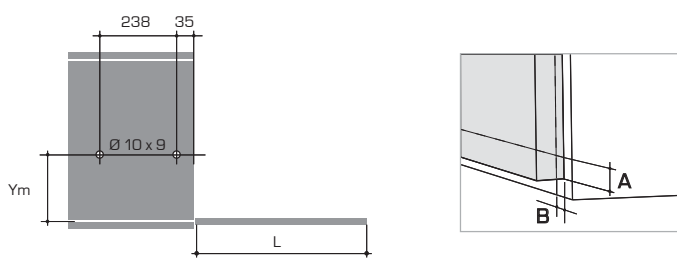

L = 200 - 300
 Ym = 122

L = 300 - 430
 Ym = 148

L = 430 - 480
 Ym = 158

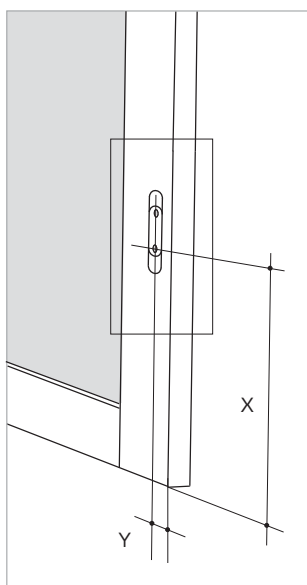
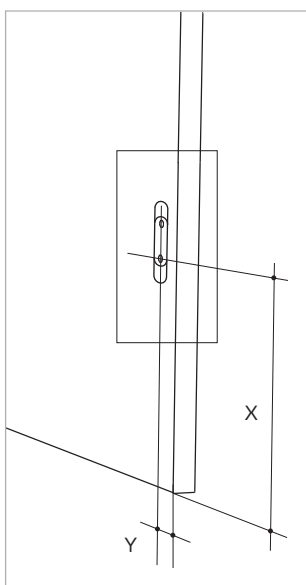

L = 200 - 300
 X = 111 + A
 Y = 16 + B

L = 300 - 430
 X = 137 + A
 Y = 16 + B

L = 430 - 480
 X = 147 + A
 Y = 16 + B

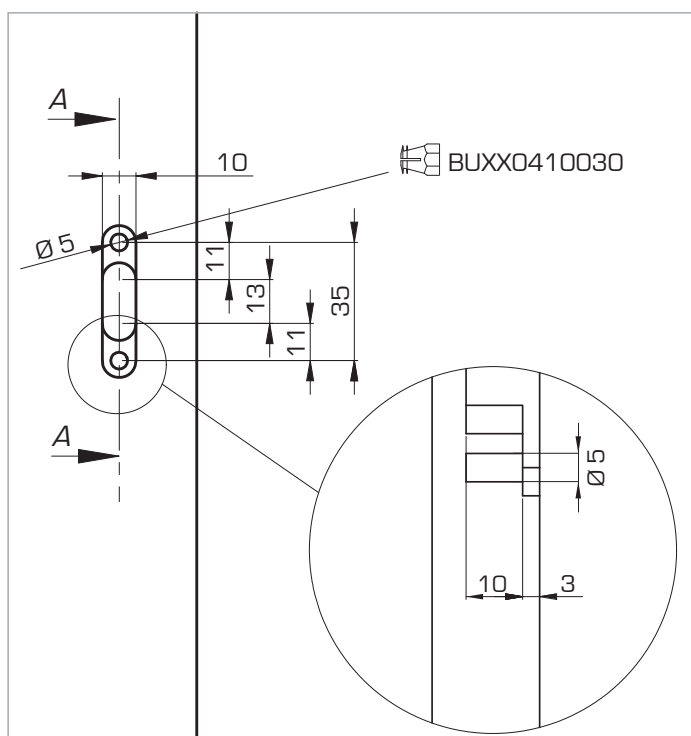

Foratura attacco anta incassato - Drilling door attachment set-in
 Bohrungen Türanbindung zum einlassen - Perçage pour mécanisme encastré -
 Taladro puerta acceso empotrado

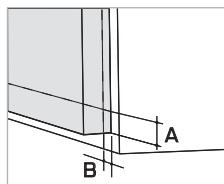
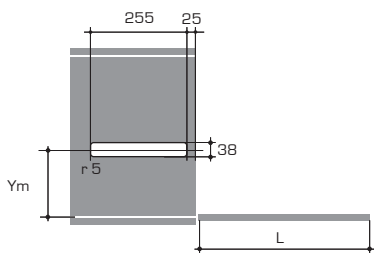

L = 200 - 300
 Ym = 122

L = 300 - 430
 Ym = 148

L = 430 - 480
 Ym = 158

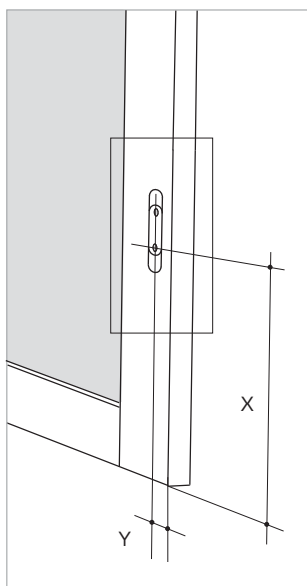
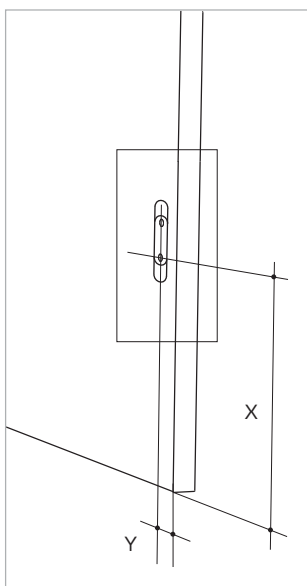

L = 200 - 300
 X = 111 + A
 Y = 7 + B

L = 300 - 430
 X = 137 + A
 Y = 7 + B

L = 430 - 480
 X = 147 + A
 Y = 7 + B

Fissaggio esterno del meccanismo - Assembly of mechanism set-on type
 Externe Montage des Mechanismus - Fixation du mécanisme en applique
 Fijación externa del mecanismo

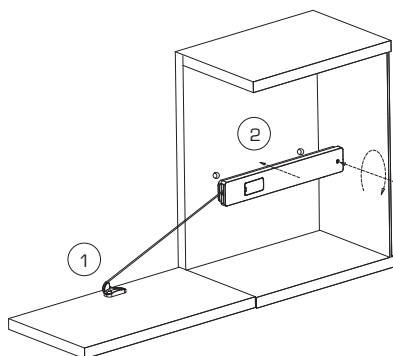
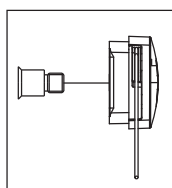
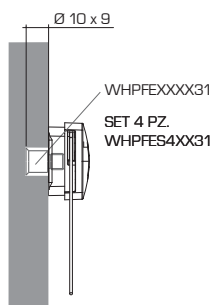

Chiave esagonale n. 3
 Hexagon key no. 3
 Inbusschlüssel SW 3
 Clef hexagonal n. 3
 Llave hexagonal n. 3

Fissaggio incassato del meccanismo - Fixing of mechanism set-in type
 Befestigung Mechanismus zum Einlassen - Fixation du mécanisme encastré
 Fijación empontrado del mecanismo

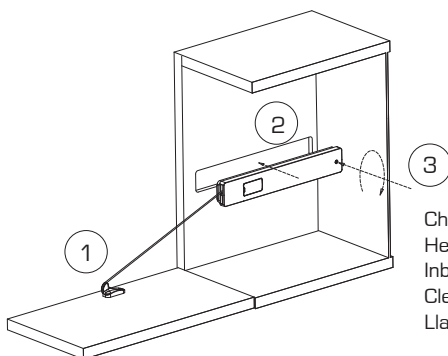
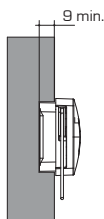

Chiave esagonale n. 3
 Hexagon key no. 3
 Inbusschlüssel SW 3
 Clef hexagonal n. 3
 Llave hexagonal n. 3

Regolazioni anta

Regulations door - Einstellung Tür
 Réglage de la porte - regulacion de la puerta

Regolazione forza apertura
 Regulations of opening force
 Einstellung der Öffnungskraft
 Réglage de la force d'ouverture
 Regulacion de la fuerza de apertura



Utilizzare cacciavite PH 2 - PZD 2
 Use screwdriver PH2 - PZD 2
 Schraubendreher PH - PZD 2
 Utiliser tournevis PH 2 - PZD 2
 Emplear destornillador PH 2 - PZD 2

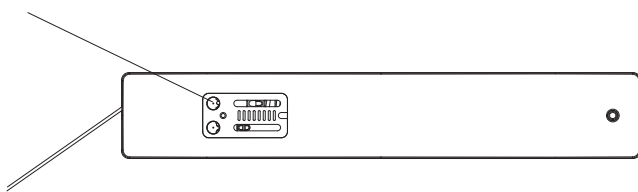

Regolazione angolo di apertura
 Regulation of opening - angle
 Einstellung des Öffnungswinkels
 Réglage de l'angle d'ouverture
 Regulacion del'angulo de apertura

Utilizzare cacciavite PH 2 - PZD 2
 Use screwdriver PH2 - PZD 2
 Schraubendreher PH - PZD 2
 Utiliser tournevis PH 2 - PZD 2
 Emplear destornillador PH 2 - PZD 2

